

# GT Exhaust Systems, Inc.

Phone: 402-323-7272 Fax: 402-323-7270

# 201-5100 Series

Critical Grade

## APPLICATION

A critical level silencer recommended for use where ambient noise levels are very low and a high degree of silencing is required. Silencer is well suited for heavy-duty stationary, marine, and mobile applications

Typical Attenuation: 25 to 33 dB'A

## INSTALLATION

May be installed in any position

## CONSTRUCTION

Silencers feature heavy-duty steel double shell construction. Standard with male threaded pipe nipples on sizes through 3.5", and 125/150# steel plate flanges on 4" and up.

## MATERIAL OPTIONS

A variety of material options are provided to satisfy most applications and budgets:

- C** Carbon Steel
- AS** Aluminized Shell
- AH** Aluminized Shell and Heads
- S** Stainless Steel

## FINISH

Standard finish is high heat silicone black or aluminum, depending on material options. Consult factory for optional coatings.

**STAINLESS STEEL OPTIONS:** 304, 316, & 316L

## CUSTOM PRODUCTS

Special requirements? GT can customize its products to meet your Specifications.

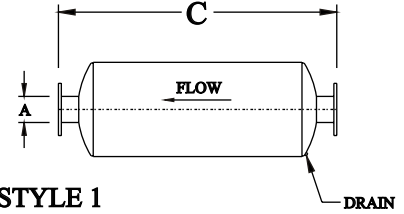
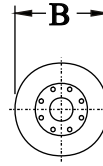

STYLE 1

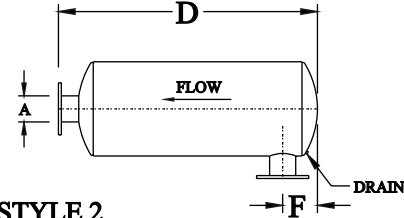
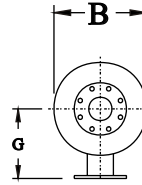

STYLE 2

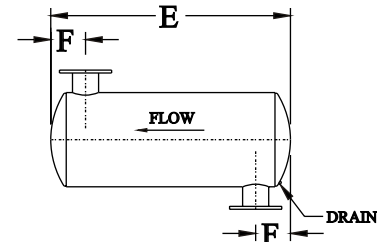
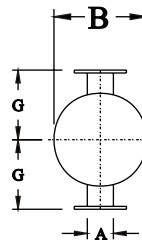

STYLE 3

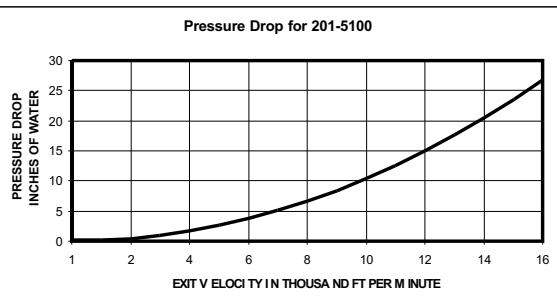
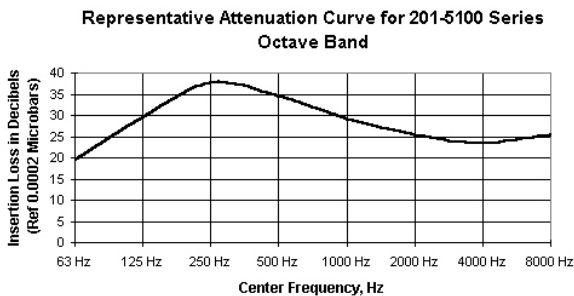

All dimensions are in inches.  
Inlet Sizes available up to 30.0"

Model	A SIZE	B DIA	C OAL-1	D OAL-2	E OAL-3	F MIN	F MAX	G	WT
201-51015	1.5	8	30	27	24	3	11	7	30
201-5102	2	10	30	27	24	6	11	8	35
201-51025	2.5	10	42	39	36	6	18	8	40
201-5103	3	12	42	39	36	6	16	9	68
201-51035	3.5	14	54	51	48	6	22	10	108
201-5104	4	14	54	51	48	6	22	11	115
201-5105	5	16	61	57	53	6	24	12	140
201-5106	6	20	74	70	66	8	30	14	175
201-5108	8	24	75	71	67	10	29	16	215
201-5110	10	28	100	96	93	12	45	18	360
201-5112	12	36	102	99	95	13	39	22	815
201-5114	14	36	138	135	132	15	57	22	940
201-5116	16	42	140	137	133	17	57	25	1130
201-5118	18	48	141	138	134	18	59	29	1480
201-5120	20	48	165	162	159	20	80	29	1660
201-5122	22	54	166	163	161	22	79	31	2010
201-5124	24	60	169	166	164	24	78	34	2775

## ORDERING INFORMATION

When ordering, please place Material and Style Options as illustrated in the examples below:

- 201-5104-2-C** Carbon Steel Construction with Style 2 -- Side Inlet
- 201-5112-3-AS** Aluminized Shell with Style 3 -- Side Inlet (x) Side Outlet
- 201-5108-1-S** Stainless Steel with Style 1 -- End Inlet