

APPLICATION

New space conserving radial design is specifically engineered to provide a high degree of attenuation in a space saving, low profile size. Ideal for engine enclosures, trailers, marine, or any application in which overall height is critical and/or low radiated heat is necessary.

Typical attenuation: 27 - 32 dB'A'

CONSTRUCTION

All welded heavy-duty steel with compressed thermal acoustical insulation inserted within the double shell construction of the silencer. Silencers are standard with 125/150#ANSI flanged inlet and outlet.

THERMAL PERFORMANCE

The 401-5100 Series utilizes an acoustical and thermal insulated packed shell. In a typical exhaust gas application, thermal conductivity (K) of the standard 401 silencer body is approximately 0.5 BTU/ft2/°F. This combined with a high surface area emissivity yields a lower surface temperature. This makes the 401 series an ideal choice for enclosures or small engine compartments. Actual figures will vary depending on application and ambient conditions. Consult with factory for further specifications and surface temperature analysis..

Additional outer thermal wraps are also available when lower surface temperatures are required.

For lower surface temperatures, see the 401-C-5100 "cool series"

MATERIAL OPTIONS

A variety of material options are provided to satisfy most applications and budgets:

- C Carbon Steel
- AS Aluminized Steel
- S Stainless Steel

FINISH

Standard finish is high heat silicone black. Consult factory for optional coatings.

STAINLESS STEEL OPTIONS: 304, 316, & 316L

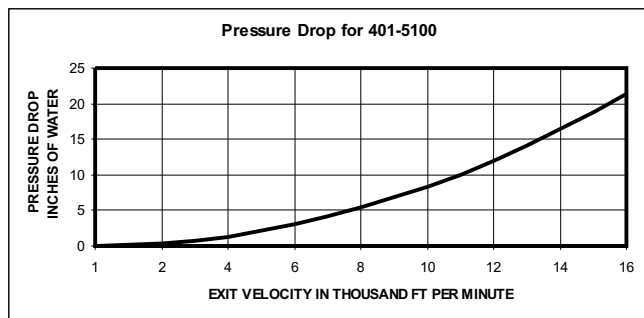
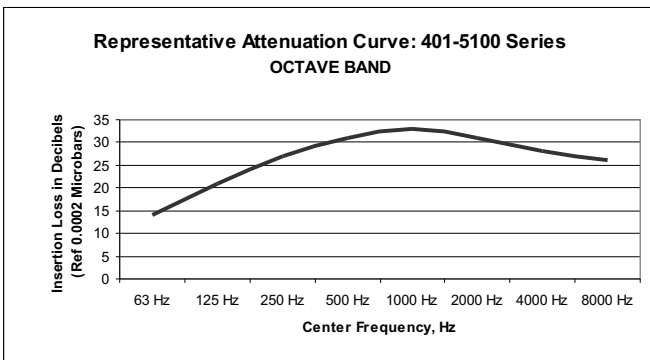
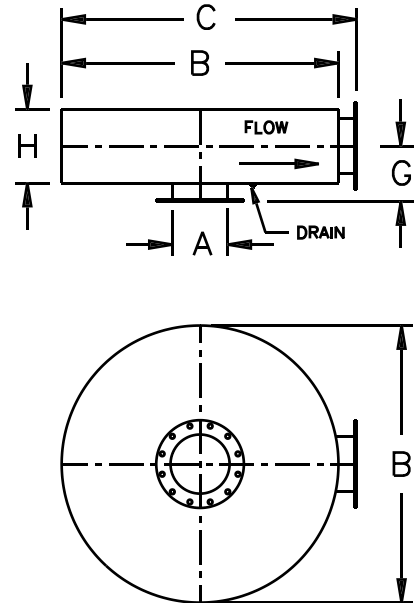

MODEL	A SIZE	B	C OAL	G	H BODY	BRACKETS	WT
401-5104	4	26	30	7.5	7	29-H-04	110
401-5105	5	27	31	10	8	29-H-05	140
401-5106	6	31	35	8.8	9.5	29-H-06	190
401-5108	8	43	47	9.5	11	29-H-08	355
401-5110	10	50	54	11	14	29-H-10	515
401-5112	12	60	64	12	16	29-H-12	710
401-5114	14	62.4	66.4	14.5	21	29-H-14	855
401-5116	16	72.4	76.4	15.5	23	29-H-16	1180
401-5118	18	82.6	86.6	16.5	25	29-H-18	1450

ORDERING INFORMATION

When ordering, please place Material Option as illustrated in the examples below:

- 401-5110-C Carbon Steel
- 401-5114-AS Aluminized Steel
- 401-5108-S Stainless Steel

When ordering brackets please specify TOP or BOTTOM Mount

All dimensions are in inches.
Consult Factory for Larger Sizes